

INFIRE™

Pre-grooved tube products for fire defence applications from Corus Tubes

Our INFIRE™ pre-grooved carbon steel tube offers a robust and cost-effective jointing method. Manufactured to exacting standards our pre-grooved tube is the latest product in our well-proven fire defence range.

INFIRE™ pre-grooved tube means it is:

- A convenient jointing method, which saves you time and money
- Suitable for use with all leading grooved couplings

Available in a choice of sizes:

- 25mm to 150mm (nominal bore)
- Medium weight per BS EN 10255⁽¹⁾
- Supplied red-painted
- Supplied in exact cut lengths (-0/+5mm tolerance)

The benefits of using INFIRE™ pre-grooved tube are:

- Simple and quick to install
- Provides a reliable and robust joint that offers consistent performance without reliance on the skill of the installer
- Clean installation means reduced flushing and commissioning time
- Complements modular construction and prefabrication techniques
- Simple accommodation of thermal movement and curved runs
- Improved pressure ratings when compared with screwed and socketed joints



Tube pressure ratings

For INFIRE™ tube, the permissible tube working pressures shown to the right are valid.

The type of grooved coupling used may also determine the maximum operating pressure of the system*.

Nominal Bore NB		Maximum operating pressure water/air ambient temperature (Bar)
(mm)	(inch)	
25	1	50.0
32-40	1 1/4 – 1 1/2	40.0
50-80	2 – 3	28.0
100-150	4 – 6	25.0

* **Note:** Please consult the relevant manufacturer's technical data.

Dimensions

- Groove diameter (C) should be measured using a 'Diameter Tape' (available from coupling manufacturers)
- The groove diameter (C) must be within the max and min tolerance shown in the table below, measured at the weld area and at 90 degrees to the weld

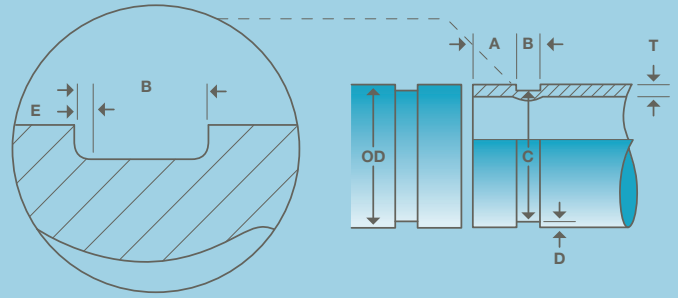

Tube data

Basic Dimensions (mm)

Nominal Bore NB	Outside Diameter		Gasket Seat A	Groove Width B	Groove Diameter C		Groove Depth D	Groove Corner E	Flare Diameter
	(mm)	(inch)			(max)	(min)			
25.0	1		15.9	7.1	30.2	29.9	1.6	2.0	36.3
32.0	1 1/4		15.9	7.1	39.0	38.6	1.6	2.0	45.0
40.0	1 1/2		15.9	7.1	45.1	44.7	1.6	2.0	51.1
50.0	2		15.9	8.7	57.2	56.8	1.6	2.0	63.0
65.0	2 1/2		15.9	8.7	72.3	71.8	2.0	2.0	78.7
80.0	3		15.9	8.7	85.0	84.5	2.0	2.0	91.4
100.0	4		15.9	8.7	110.1	109.6	2.1	2.0	116.8
125.0	5		15.9	8.7	135.5	135.0	2.1	2.0	142.2
150.0	6		15.9	8.7	160.8	160.2	2.2	2.0	167.6

References

- [1] BS EN 10255: 2004-A1: 2007 Non-alloy steel tubes suitable for welding and threading. Technical delivery conditions.

Corus Tubes

PO Box 101

Weldon Road

Corby, Northants

NN17 5UA

T: +44 (0)1536 402121

F: +44 (0)1536 404111

www.corusgroup.com/conveyance

marketing@corusgroup.com

Care has been taken to ensure that this information is accurate but Tata Steel Europe Limited and its subsidiaries, does not accept responsibility or liability for errors or information which is found to be misleading.

Copyright 2009

Corus